

Triflex

Delivering solutions together.

From the liquid-applied waterproofing specialist

Simply intelligent waterproofing.



Triflex SmartTec

Simply
intelligent
waterproofing.

NEW



Triflex SmartTec

Fundamentally waterproof.

The requirements for structures are complex and thus new challenges for waterproofing systems are constantly presented. The new Triflex SmartTec technology is the first solution which can be used to provide durable protection, even in areas where other systems often only achieve insufficient and costly results. These include damp mineral substrates, such as foundations or bases, ornamental fountains and water tanks. Even indoor equipment rooms or buildings with heightened demands for the environment and health, such as nurseries or hospitals, are waterproofed with Triflex SmartTec securely and reliably from the ground up. And all this with just one material – easy to apply, reliable, and highly efficient.

Triflex SmartTec strengths

From us. For you. Great advantages.

Single-component solution, no mixing required.

Simple, assured application and high reliability.

Vapour-permeable system, low S_d value $< 2.0 \text{ m}$.

Problem-free adhesion and high drying capability, even on damp mineral substrates.

Free from solvents and isocyanates, low-odour.

Particularly suitable for odour-sensitive areas, e.g. nurseries and hospitals.

Usable on almost all substrates without a primer.

Highly economical with a high level of planning reliability.

Thoroughly impressive.



Unbeatably versatile.

Refurbishment, repairs, foundations, ornamental fountains, equipment rooms, sprinkler tanks, hospitals, various substrates etc.: With Triflex SmartTec you have the ideal, customised and long-lasting solution for all waterproofing requirements.



Extremely durable.

Triflex SmartTec has General Building Supervisory Authority test certification (abP) and has been tried and tested in comprehensive tests and practical use. The expected service life in accordance with ETAG 005 is 25 years.



Extremely waterproof down to the smallest detail.

Joints, connection details, structural movement where components meet or in cracks: Triflex SmartTec comes into its own when handling complicated details. The flexible material together with the fleece reinforcement ensures seamless and jointless waterproofing.



Odourless: The solvent-free system facilitates odourless application in indoor equipment rooms.



With immediate effect: Triflex SmartTec can be applied to concrete without primer, and is immediately fully functional.



Fast-drying: Triflex SmartTec adheres problem-free to damp mineral substrates. The moisture can escape, the foundation subsequently dries out quickly.

Triflex SmartTec strengths

Waterproof right down to the base.

Triflex SmartTec is a fleece-reinforced, single-component solution for waterproofing foundations and bases in areas that are in contact with soil. It can be applied to almost all substrates without primer – no primer is needed – even on damp concrete. Triflex SmartTec is also ideally suitable for use in odour-sensitive areas. Triflex SmartTec is applied in a liquid form, wet-on-wet, and cures rapidly to create a long-lasting and flexible finish – even on damp concrete.

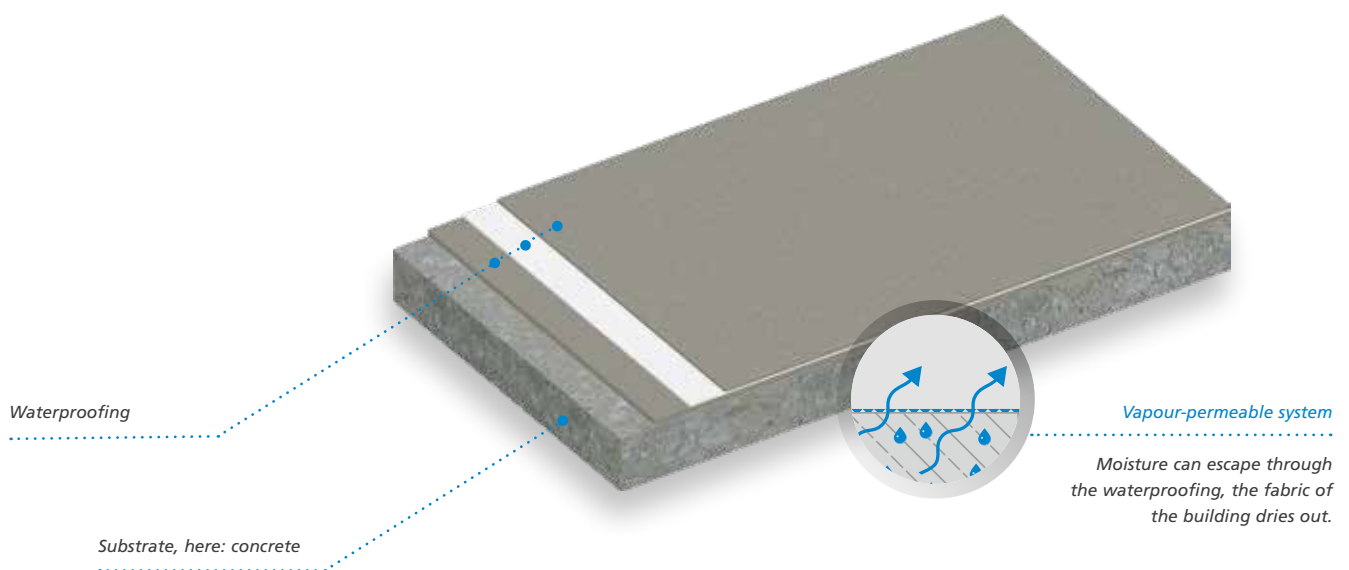

Exceptional quality. Exceptional conformity.

With Triflex SmartTec you have complete peace of mind whatever the application. At Triflex, we regard continuous internal and external quality controls in production and extensive field tests prior to market launch as essential.

- **Certified safety in accordance with the General Building Supervisory Authority Test Certificate (abP) for structure waterproofing and the abP for roof waterproofing.**
- **Certified safety as per ETAG 005.**
- **B_{ROOF} (t1), B_{ROOF} (t2) and B_{ROOF} (t4).**

Triflex SmartTec

Multiple applications. One solution.

Strengths

- + Full-surface, fleece-reinforced waterproofing system with a single-component polyurethane base
- + Adhesion on damp concrete without primer
- + Free from solvents and isocyanates, ideal for odour-sensitive areas
- + Fire classification as per DIN EN 13501-1: Class E
- + Resistant to external fire exposure as per DIN EN 13501, $B_{ROOF}(t1)$, $B_{ROOF}(t2)$ and $B_{ROOF}(t4)$
- + UV stable, hydrolysis and alkali resistant

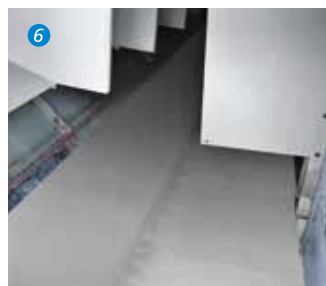
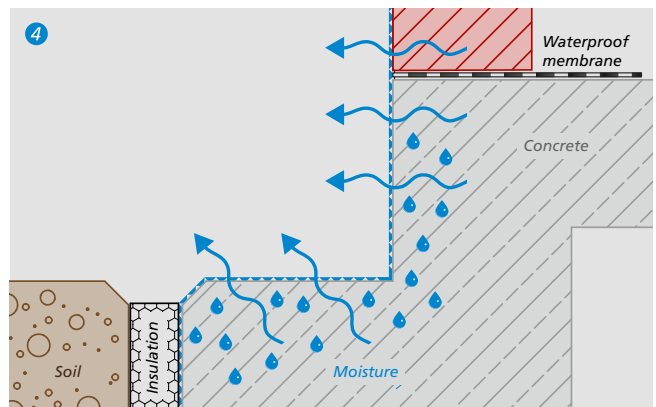

Application examples:

- 1 Foundation waterproofing
- 2 Ornamental basin
- 3 Fermentation tank
- 4 Permanently damp substrates can cause lasting damage to the fabric of the building. Triflex SmartTec has a low S_d value of < 2.0 m. The trapped moisture can diffuse out, providing lasting prevention of damage.
- 5 Stepped foundation
- 6 Tank

A selection of our additional products

Anything is possible. Everything is watertight.

Triflex SmartTec can be applied to most substrates without primer. Our range includes solutions for special applications where you can work quickly and simply without the need for extensive preparation work. We also have a solution for the reliable waterproofing of complex details when it is not possible to use fleece reinforcement.

Primers

Triflex Metal Primer

Metal substrates

- + Alternative to protracted grinding
- + Suitable for all metal surfaces, e.g., copper and stainless steel
- + Even for rusty substrates
- + Fast drying with fast recoat time



Complementary products

Triflex SmartTec Fibre

Hard-to-reach details

- + Single-component polyurethane
- + Free from solvents and isocyanates, and low-odour
- + Fibre-reinforced, highly elastic waterproofing



Triflex Than Primer 533

PVC substrates

- + Polyurethane-based primer
- + Single-component and with solvent content
- + Fast drying
- + Can be recoated after approx. 20 minutes at +20 °C



Triflex Special Fleece SK

Vertical joints

- + Self-adhesive fleece polyester
- + Material-strengthening and crack-bridging
- + Perfect, simple secure
- + Tried-and-tested waterproofing for construction joints and on vertical surfaces





Triflex project expertise

As a manufacturer and direct distributor of liquid-applied waterproofing for roofs, balconies, multi-storey car parks and much more, we have 40 years of project experience and always offer customised solutions to meet your requirements. We ensure ideal cooperation between contractors, planners, our staff and systems. The channels are short and direct, and personal contact is guaranteed without complications. Welcome to the Triflex family.



Triflex training expertise

We communicate our know-how directly and bypass trade intermediaries: we train and provide advice before, during and after the project. This guarantees the best possible application results, optimum solutions and long-term satisfaction.

MORE
THAN JUST
STRUCTURE
WATERPROOFING.



Triflex quality

- Certified safety in accordance with the General Building Supervisory Authority Test Certificate (abP) for structure waterproofing and the abP for roof waterproofing
- Certified safety as per ETAG 005
- Innovative binding agent technology
- Continuous internal and external quality controls, and enhancement and optimisation of products



Triflex service

This is where we as a manufacturer and direct distributor are closer to the action: we support and supervise your project with our technical advisers and applications engineers. We deliver to the construction site on schedule, offer advice from the word go, help you with offers and use our technical expertise to assist with execution and, in doing so, guarantee the long-term success of your project.



Delivering solutions together.



International

Triflex GmbH & Co. KG
Karlstrasse 59
32423 Minden | Germany
Fon +49 571 38780-708
international@triflex.com
www.triflex.com